

14

State of Florida
 County of Palm Beach
 This Plat Was Filed For
 Record At _____ On The
 Day Of _____ 1998
 In Plat Book _____ Page _____
 John D. Duple
 Clerk of Circuit Court
 By _____

PHEASANT WALK SECTION FIVE

A PARCEL OF LAND IN THE SOUTH ONE-HALF OF SECTION 36, TOWNSHIP 46
 SOUTH, RANGE 42 EAST, PALM BEACH COUNTY, FLORIDA



SHEET 2 OF 2 SHEETS

Prepared by I.D. Dickham in the Offices of:
 ARTHUR V. STROCK & ASSOCIATES, INC.
 Consulting Engineers — Land Surveyors
 Deerfield Beach — Delray Beach, Florida
 Comm No. 4853-U
 FB 240

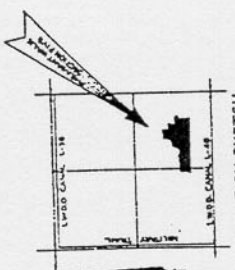

LOCATION SKETCH
 SEC. 36, TWP. 46 S., RGE. 42 E.
 NOT TO SCALE



- SURVEYOR'S NOTES**
1. Letter indicates Permanent Reference Monument.
 2. Letter indicates Permanent Control Point.
 3. UE indicates Unreliable Monument.
 4. Letter indicates Proposed Easement.
 5. A bearing of North Was Assumed for the West Line of Section 36.
 6. No Building or Any Kind of Construction or Erection Shall Be Placed on Easements.
 7. Finish Elevation Shall be a Minimum of 18 Inches above the Crown of Road or 16.0 NGVD, whichever is higher.

SOUTH PLAT, P.C. No. 1074475

BY CURVES, P.C. 14-44-41